

DO NOT SCALE FROM THE DRAWING. ONLY FIGURED DIMENSIONS ARE TO BE USED.

ALL DIMENSIONS ARE TO BE CHECKED ON SITE BY THE CONTRACTOR.

ALL DIMENSIONS ARE IN MILLIMETERS U.N.O.

THIS DRAWING IS TO BE READ IN CONJUNCTION WITH ALL RELEVANT ARCHITECTS AND ENGINEERS DRAWINGS AND SPECIFICATIONS.

**LEGEND**

7.07	EXISTING SPOT ELEVATION
× XX.XXXm	PROPOSED SPOT ELEVATION
FFL XX.XXXm	PROPOSED FINISHED FLOOR LEVEL
→	DIRECTION OF SLOPE IN SURFACE

**HAZARD IDENTIFICATION NOTES**

- 1 WORKING ON LIVE SEWERS**

Only personnel with confined space entry certification are permitted to enter manholes or similar confined spaces.

Site personnel to work in pairs at all times when working at live sewers here.
- 2 WORKING ON PUBLIC ROAD**

All services should be traced and located on site prior to works commencing, this should include hand excavation to visually locate critical services. All excavation should be carried out on the basis that unknown services are present until confirmed otherwise.
- 3 STABILITY OF PLANT**

Only certified, experienced drivers are to operate plant on site. Appropriate certificates for plant operators must be included in the health and safety plan for inspection.

Movement on slopes is to be restricted to up and down the bank only. If steep they must not be traversed.
- 4 WORKING AT HEIGHT**

Contractor to provide safe working platforms, and secure edge protection, to the sides of all working excavations.
- 5 STABILITY OF EARTH FACE**

Site investigation to be referenced.

Excavations greater than 1.2m should be supported by timbering and props or similar proprietary system.

Spoil should not be heaped immediately to the side, a gap equal to the depth of excavation should be left.

All open trenches or holes should be protected with barriers to prevent site personnel and plant falling in.

Trench fill excavations should be refilled with concrete as they are excavated.
- 6 DRAINAGE WORKS**

The drainage works will require deep excavations, as per usual work methods, any excavation over 1.2m must have side support and works must be undertaken in accordance with standard safe working practices. In certain ground conditions support will be required for trenches less than 1.2m.

The contractor must employ suitable techniques for the ground conditions encountered and provide suitable detailed method statements.
- 7 DISPOSAL OF SOIL**

Information is not currently available to determine if contamination is a problem. The contractor cannot assume that the ground is contamination free. Investigations must be undertaken before construction commences and the spoil dealt with accordingly.

OR

The ground is known to contain contaminants harmful to human, plant and animal life. Contamination experts must be used to deal with this material and materials must only be moved to licenced contamination dumps. Proof will be required.

**NOTE:**

EVERYDAY OR LOW RISK HAZARDS HAVE NOT BEEN INDICATED ON THIS DRAWING, NEITHER HAVE HAZARDS THAT SHOULD BE OBVIOUS TO A COMPETENT CONTRACTOR.

SHOULD ANY ADDITIONAL HAZARDS BE IDENTIFIED THE CONTRACTOR SHOULD NOTIFY ALL THE RELEVANT PROJECT TEAM LEADERS.

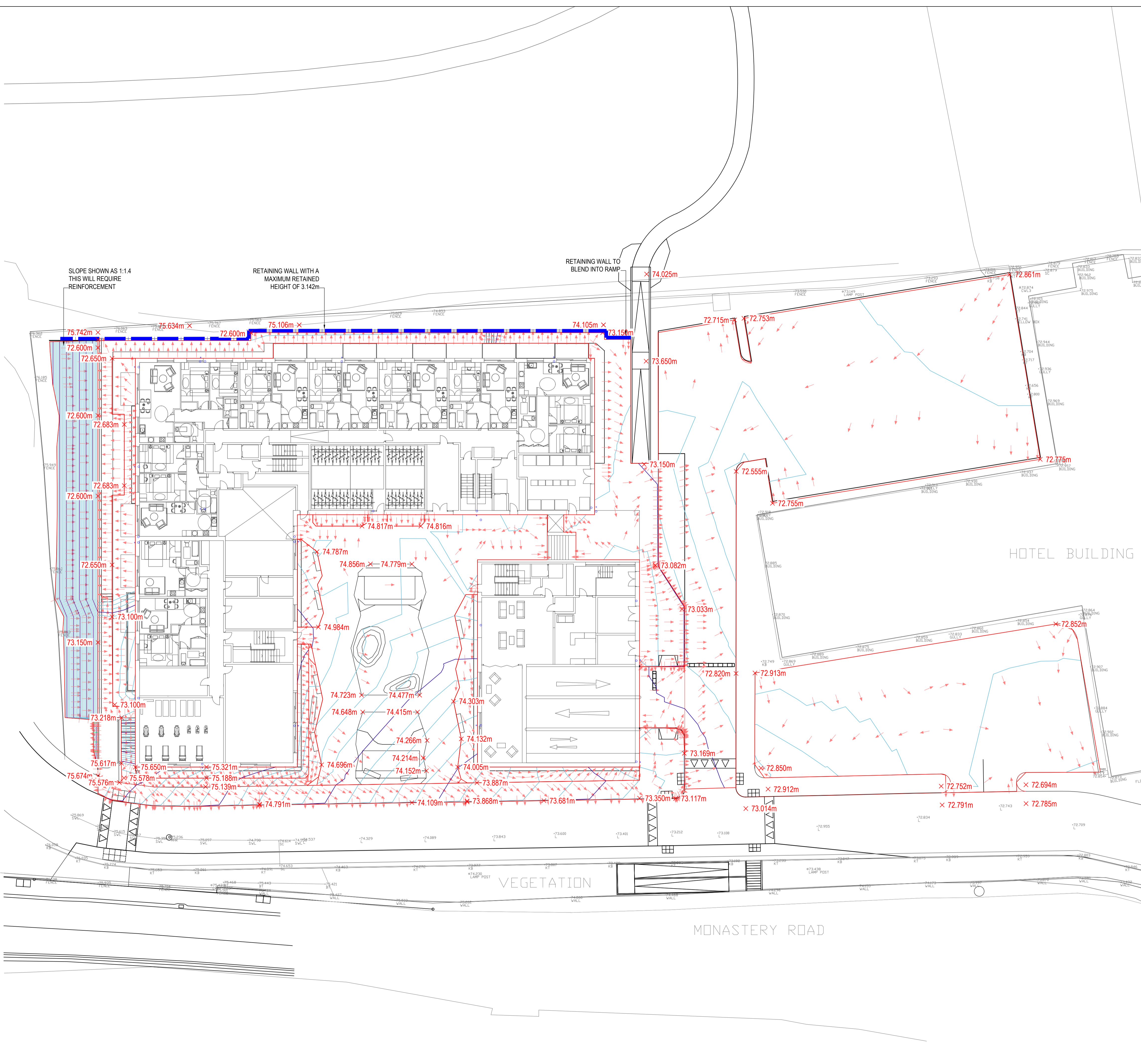

P3	ISSUED FOR INFORMATION	09.09.22	CPL	AnH
P2	ISSUED FOR INFORMATION	08.09.22	CPL	AnH
P1	ISSUED FOR INFORMATION	22.10.21	CPL	AnH
Rev	Amendment	Date	By	Chk

**TAYLOR+BOYD**  
 Consulting Structural and Civil Engineers  
 www.taylor-boyd.co.uk  
 Belfast: (028) 9066 7951 Derry: (028) 7126 7115

Status: **FOR APPROVAL**

Project: **RESIDENTIAL ACCOMMODATION MONASTERY ROAD, DUBLIN**

Dwg Name: **PROPOSED SITE LEVELS LAYOUT**

Client/Architect: **DUDDY GROUP / SHANE BIRNEY ARCHITECTS**

Scale: (@ A1)	Date:	Drawn:	Checked:
1:200	OCT 2021	CPL	AnH
Drawing No:	19818-(P1)C100	Rev:	P3