

Tree Protection Specification - Above ground stabilizing system

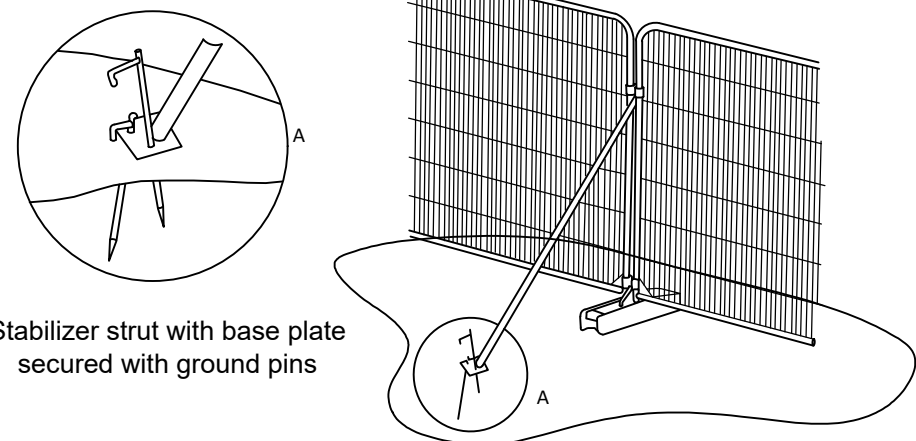

Stabilizer strut with base plate secured with ground pins

Stabilizer struts installed on every fencing panel section on the tree protection side

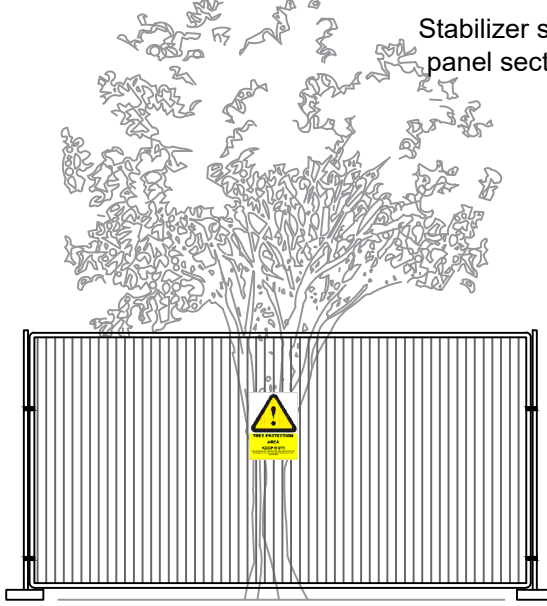

BS5837:2012 Figure 3

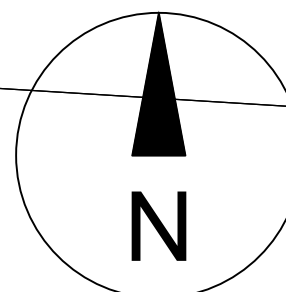

This drawing is to be read in conjunction with the respective arboricultural schedules and reports relevant to this project.

Where contradictions between this drawing and any other design information becomes apparent, the respective authors should be contacted immediately.

It is the responsibility of the main site contractor to check and verify all information and measurements onsite and confirm prior to the commencement of works, and to ensure that all site operatives work in accordance with respective arboricultural reports and BS5837:2012. Trees in relation to design, demolition and construction.

BS5837:2012 Tree Categorisation

- Category A**
Trees of high quality with an estimated remaining life expectancy of at least 40 years
- Category B**
Trees of moderate quality with an estimated life expectancy of at least 20 years
- Category C**
Trees of low quality with an estimated life expectancy of at least 10 years, or young trees with a stem diameter below 150mm
- Category U**
Those in such a condition that they cannot realistically be retained as living trees in the context of the current land use for longer than 10 years

Key

- Root Protection Areas**
The minimum area around a tree deemed to contain sufficient roots and rooting volume to maintain the trees viability.
- Tree, Shrub or Hedgerow Group.**
- T2**
Reference Number for Tree, Group or Hedgerow.
- Tree Protection Zone - Protective fencing to be installed as per Specification. Designated Construction Exclusion Zone.**
- Proposed foul water drainage run. Location of run and any associated tree works to be agreed onsite with SDCC Parks prior to installation.**
- Ground Floor layout in Black.**
- Basement layout in dashed Green.**
- Site boundary.**

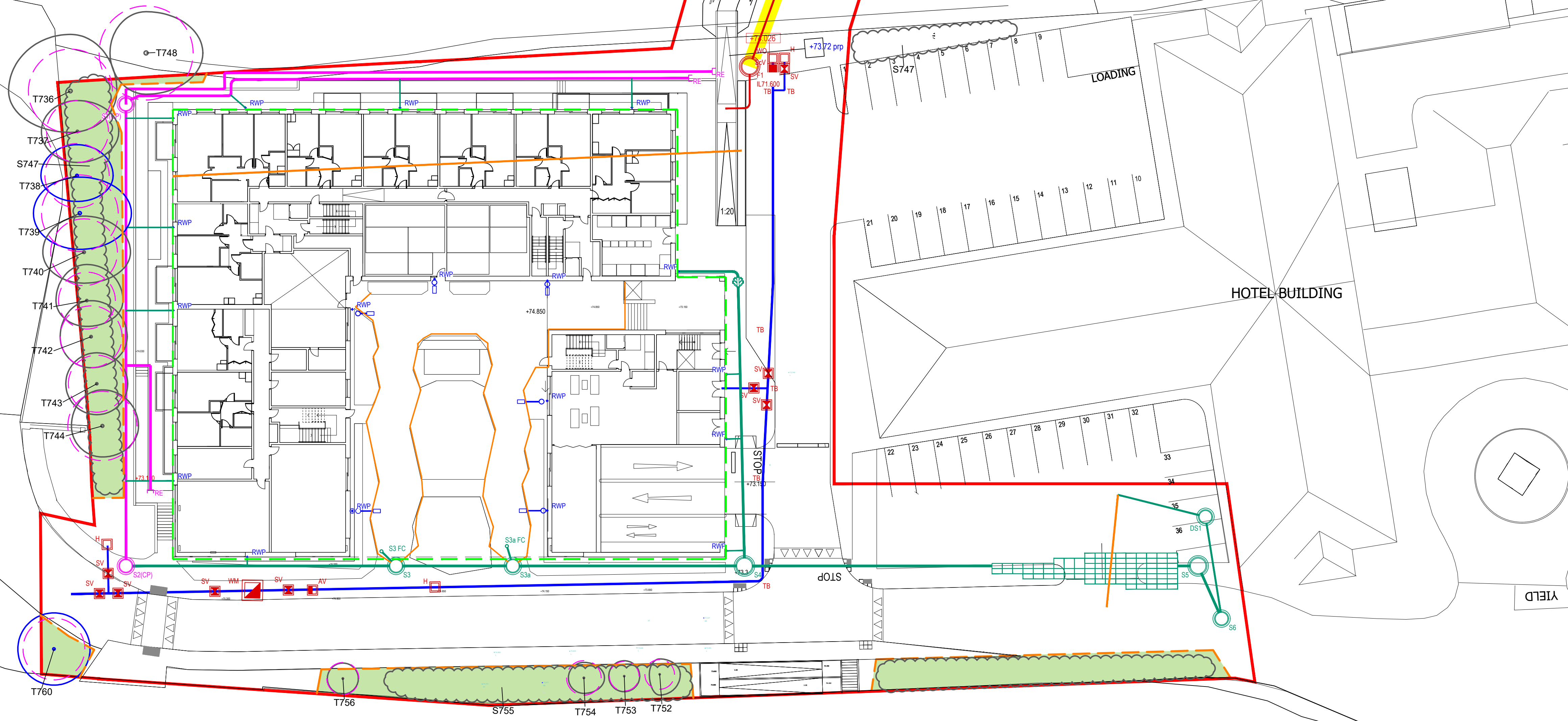

| Revision | Date | Description |
|----------|------|-------------|
| | | |

Title:
Tree Protection Plan

Project:
Lands at IBIS Hotel

Client:
Propiteer Ibis Red Cow Limited

| | | |
|------------------|----------------------|------------------|
| Date: Sept 2022 | Scale: 1:250 @ A1 | Status: Planning |
| Drawn by: CMcC | Dwg ref: 181106-P-12 | Rev: - |
| Checked by: CMcC | | |

This drawing is the copyright of Charles McCorkell Arboricultural Consultancy has been produced for the client and project as stated above. The drawing may not be reproduced or amended, except by the written permission of Charles McCorkell Arboricultural Consultancy. No liability will be accepted for any amendments made by other persons.

CHARLES MCCORKELL
ARBORICULTURAL CONSULTANCY

T: 085 843 7015 / E: charles@cmarbor.com / W: www.cmarbor.com